

Eilon RON 2501 Hook Crane Scale/Shackle Dynamometer w/Wireless Indicator

NEW!
Product



Hook Type



Shackle Type
(shown with optional shackles)

(SEE CHART ON BACK OF PAGE FOR PART #'S)



Providing ultimate versatility, the RON 2501 is a wireless, multi-function crane scale/dynamometer for use in environments where cables can't survive. This compact model is powered by rechargeable batteries, and is equipped with low battery warning lights. In addition, automatic shut-off (after 1.5 hours) conserves power when not in use. Each system is easily user calibrated, and includes a test certificate and fully traceable calibration chart.

The RON 2501 is loaded with high-performance features. A large six-digit LCD shows weight in unmatched clarity. Standard keys include zero, tare and peak hold for detecting maximum loads. With two available frequencies, up to 12 systems can operate simultaneously in any one area.

To enhance safety, the RON 2501 incorporates an error detection mechanism that ensures it will not display an incorrect weight value. If environmental conditions interfere with the weighing process, the system will read "transmission error." Each RON 2501 has also been proof tested to 200%, and features a safety factor of 5:1 as well as a two-level overload warning. Known for their reliability, the RON 2501 load cells are constructed of high strength, aerospace quality, alloy steel and coated with polyurethane for long-lasting performance. They're also extremely compact to guarantee portability and minimal headroom loss in any application.

The RON 2501 is available with a variety of precision-crafted hooks for lifting applications up to 20,000 lbs. Choose shackles for lifting up to 600,000 lbs or measuring horizontal force in tie-down, towing, suspension or side-loading applications. Shackle versions are easily disassembled and transported in a specially fitted carrying case.

Applications

- Foundry applications
- Weighing parts during manufacturing process
- Tug boat performance tests
- Material strength tests
- Checking incoming raw materials from suppliers

Standard Features

- Two level overload warning
- Auto shut-off after 1.5 hours (indicator only)
- Rechargeable batteries, up to 50 hours continuous use for load cell and up to 25 hours continuous use for indicator
- Low battery warning (load cell and indicator)
- User calibration
- Operator keypad: PEAK HOLD, ENTER, ZERO, TARE, ESC, and ON/OFF
- Six-digit, 0.75" (19mm), Liquid Crystal Display (LCD)
- Low headroom

Shackle Type additional features:

- Special perpendicular hole structure ensures neutralization of external moments
- Carrying case

Options/Accessories

- Heat shield
- RS-232 continuous output, 9600 baud, eight data bits, one stop bit, no parity (includes mating connector only, cable not included)
- Two user-adjustable setpoints
- 66' (20m) range RF wireless remote control to switch load cell on and off
- User-adjustable auto shut-off (60-5900 seconds)
- Low temperature -13°F (-25°C)
- High temperature 175°F (80°C)
- User-selectable baud rate (1200-9600)
- User-selectable units of measure (lb, metric tons, short tons, and kilo-newtons)
- Additional remote displays with cable or wireless connection: 1.6" (40mm) Liquid Crystal Display (LCD)

Note: All options/accessories must be installed at time of order.

RANGE:

At least 50 yards (50m) in normal operating conditions

WIRELESS/RF:

300 ft, outside line of sight; 150 ft, indoor line of sight;
75 ft, indoor not line of sight

SAFETY FACTOR:

Hook Type: 5:1 for load cell. 5:1 for the lifting eye. Average
straightening load of the hook is at least 4 times the capacity
Shackle Type: 5:1 for load cell

PROOF LOAD:

200% of rated capacity (certified)

ACCURACY:

± 0.1% of full range

ENCLOSURE:

Robust extruded aluminum housing. Iridized and polyurethane
coated

INDICATOR DISPLAY:

Six-digit, 0.75" (19mm), Liquid Crystal Display (LCD) and annun-
ciators: two level overload warning, max. value (peak hold),
low battery (load cell & indicator), tare state, and programming
instructions

UNITS:

lb (consult factory to order a scale configured/defaulted for
other units of measurement)

LOAD CELL:

High strength, aerospace quality, alloy steel, and polyurethane
coated

Hook and lifting eye are Crosby-Laughlin or equivalent

POWER:

Rechargeable batteries provide power for up to 50 hours con-
tinuous use for load cell and up to 25 hours continuous use for
indicator. All data settings are retained at power off

CALIBRATION:

Factory calibrated, fully traceable (certificated)

TEMPERATURE RANGE:

14°F to 140°F (-10°C to 60°C)

ENVIRONMENTAL:

Weatherproof, NEMA 4, IP65

RADIO:

Frequency Modulation (F.M.) radio transmission with error
detection for high reliability telemetry

APPROVALS:

CE marked

WARRANTY:

One year limited warranty

RON 2501 HOOK TYPE

PART #	CAPACITY	A	B	C	D Ø	E	H	L
68326.....	500 lb x 0.2 lb.....	2.0"	1.5"	0.875"	0.5"	1.0"	10.0"	6.3"
68327.....	1000 lb x 0.5 lb.....	2.0"	1.5"	0.875"	0.5"	1.0"	10.0"	6.3"
68328.....	2000 lb x 1.0 lb.....	2.0"	1.5"	0.875"	0.5"	1.0"	10.0"	6.3"
68329.....	2500 lb x 1.0 lb.....	2.0"	1.5"	0.875"	0.5"	1.0"	10.0"	6.3"
68330.....	3200 lb x 1.0 lb.....	2.0"	1.5"	0.875"	0.5"	1.0"	10.0"	6.3"
68331.....	5000 lb x 2.0 lb.....	2.625"	2.0"	1.125"	0.75"	1.125"	11.5"	6.5"
68332.....	6000 lb x 2.0 lb.....	2.625"	2.0"	1.125"	0.75"	1.125"	11.5"	6.5"
68333.....	6400 lb x 2.0 lb.....	2.625"	2.0"	1.125"	0.75"	1.125"	11.5"	6.5"
68334.....	10,000 lb x 5.0 lb.....	3.5"	2.5"	1.5"	1.0"	1.4375"	13.0"	6.7"
68335.....	20,000 lb x 10.0 lb.....	4.0"	3.125"	2.25"	1.25"	2.25"	19.0"	6.7"

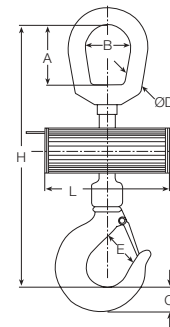

RON 2501 SHACKLE TYPE (SHACKLES NOT INCLUDED - refer to catalog page CS-9)

PART #	CAPACITY	LOAD CELL WEIGHT	H1 MAX.	H2 MAX.	B MAX.	L MAX.	D1 MAX.	D2 MIN.	ANCHOR/SHACKLE
68304.....	500 lb x 0.2 lb.....	2.5 lb (1.1 kg)	4.8"	3.7"	0.7"	6.3"	1.2"	0.66"	1/2", 7/16", 3/8"
68305.....	1000 lb x 0.5 lb.....	2.5 lb (1.1 kg)	4.8"	3.7"	0.7"	6.3"	1.2"	0.66"	1/2", 7/16", 3/8"
68306.....	2000 lb x 1.0 lb.....	2.5 lb (1.1 kg)	4.8"	3.7"	0.7"	6.3"	1.2"	0.66"	1/2", 7/16", 3/8"
68307.....	4000 lb x 2.0 lb.....	2.5 lb (1.1 kg)	4.8"	3.7"	0.7"	6.3"	1.2"	0.66"	1/2", 7/16", 3/8"
68308.....	6000 lb x 2.0 lb.....	2.5 lb (1.1 kg)	5.4"	4.0"	0.75"	6.3"	1.5"	0.82"	5/8", 1/2"
68309.....	10,000 lb x 5.0 lb.....	2.7 lb (1.2 kg)	5.7"	4.2"	1.0"	6.6"	1.75"	0.9"	3/4", 5/8"
68310.....	20,000 lb x 10.0 lb.....	4.5 lb (2 kg)	7.7"	5.3"	1.6"	6.7"	2.4"	1.4"	1 1/4", 1 1/8", 1"
68311.....	25,000 lb x 10.0 lb.....	4.5 lb (2 kg)	7.7"	5.3"	1.6"	6.7"	2.4"	1.4"	1 1/4", 1 1/8", 1"
68312.....	30,000 lb x 10.0 lb.....	7 lb (3 kg)	8.1"	5.3"	1.8"	6.9"	2.8"	1.4"	1 1/4", 1 1/8"
68313.....	40,000 lb x 20.0 lb.....	7.3 lb (3.3 kg)	8.7"	5.6"	2.1"	6.9"	3.2"	1.55"	1 3/8"
68314.....	50,000 lb x 20.0 lb.....	9 lb (4 kg)	9.2"	5.9"	2.3"	7.1"	3.4"	1.7"	1 1/2"
68315.....	60,000 lb x 20.0 lb.....	9 lb (4 kg)	9.2"	5.9"	2.3"	7.1"	3.4"	1.7"	1 1/2"
68316.....	80,000 lb x 50.0 lb.....	18 lb (8 kg)	11.8"	7.6"	2.8"	7.5"	4.5"	2.3"	2", 1 3/4"
68317.....	100,000 lb x 50.0 lb.....	18 lb (8 kg)	11.8"	7.6"	2.8"	7.5"	4.5"	2.3"	2", 1 3/4"
68318.....	160,000 lb x 100.0 lb.....	38 lb (17 kg)	15.8"	10.4"	3.8"	8.1"	5.7"	3.0"	2 1/2"
68319.....	250,000 lb x 100.0 lb.....	66 lb (30 kg)	18.0"	11.8"	4.8"	8.5"	6.5"	3.18"	Crosby #2160, 125t
68320.....	400,000 lb x 200.0 lb.....	121 lb (55 kg)	22.8"	15.0"	5.7"	9.9"	8.3"	4.2"	Crosby #2160, 200t
68321.....	500,000 lb x 200.0 lb.....	103 lb (227 kg)	31.3"	19.7"	7.0"	11.6"	10.0"	5.2"	Crosby #2140, 250t or #2160, 300t
68322.....	600,000 lb x 200.0 lb.....	103 lb (227 kg)	31.3"	19.7"	7.0"	11.6"	10.0"	5.2"	Crosby #2160, 300t

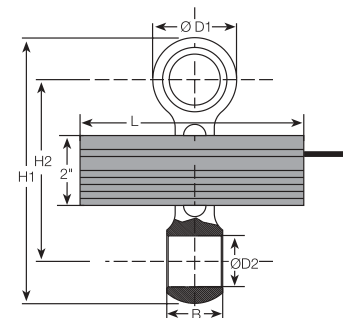

IMPORTANT: Please advise our sales staff if you are ordering more than one RON 2501 to be used in the same area so they can ensure you receive scales with different code numbers. If you are ordering a single scale to be used in an area where other RON 2501 scales already exist, please call with the code number on existing scale.