

## Eilon RON 2300 Hook Crane Scale/Shackle Multi-Functional Dynamometer

**NEW!**  
Product



Hook Type



Shackle Type  
(shown with optional shackles)

(SEE CHART ON BACK OF PAGE FOR PART #'S)



The RON 2300 crane scale/dynamometer combines ease of use with a variety of performance enhancing features for more sophisticated applications.

This portable model features peak hold for capturing maximum values, and a totalizer function for accumulating load values. Ideal for dynamic loads, the RON 2300 allows you to select measuring and display update rates between 0.2 sec. and 1 sec. Two pairs of user-adjustable setpoints allow command output to control any system. Data transfer is enabled with analog output and RS-232 serial communication, or choose optional Data Logger to store data right in the system. The RON 2300 is also available with optional multi-capacity function, allowing one indicator to read multiple load cells.

The RON 2300's easily readable LCD displays weight in four digits. It's conveniently powered by rechargeable batteries that operate for up to 25 continuous hours, retaining data during power off. All units are factory calibrated and easily recalibrated in the field. Load cells are constructed of high grade alloy steel reinforced with polyurethane for long lasting performance in adverse environments. They're also extremely compact to guarantee portability and minimal headroom loss in any application.

The RON 2300 is available with a variety of precision-crafted hooks for lifting applications up to 20,000 lbs. Choose shackles for lifting up to 600,000 lbs or measuring horizontal force in tie-down, towing, suspension or side-loading applications.

### Applications

- Transportation/carriage charges
- Weighing long rolls by totaling the reading of two load cells located at each end of the beam that lifts the rolls
- Material strength tests
- Checking incoming raw materials from suppliers

### Standard Features

- Two pairs of user-adjustable setpoints
- User calibration
- Selectable sampling rates (ideal for dynamic loads)
- Peak hold
- Totalizer
- Rechargeable batteries, up to 25 hours continuous use
- Low battery warning
- Operator keypad: SP1, SP2, CAL, UNITS, SAMPLE, PRINT, CLOCK, MAX, TOTAL, ZERO, ON, OFF
- User-selectable units of measure (metric tons, lb, short tons, kilo-newtons, and British tons)
- Four-digit Liquid Crystal Display (LCD)
- Quick-response analog output 0-2V
- RS-232 serial output
- Auto shut-off after 10 to 30 minutes
- Low headroom

#### Shackle Type additional features:

- Special perpendicular hole structure ensures neutralization of external moments
- Carrying case

### Options/Accessories

- Multi-capacity: allows one indicator to read up to three different pre-calibrated load cells of varying capacities
- Data logging: stores data and time (up to 2000 measurements) with print capacity
- Load cell with underwater capability (2' max. depth)
- Low temperature -13°F (-25°C)
- High temperature 175°F (80°C)

**NOTE:** All options/accessories must be installed at time of order.

## SAFETY FACTOR:

Hook Type: 5:1 for load cell. 5:1 for the lifting eye. Average straightening load of the hook is at least 4 times the capacity  
Shackle Type: 5:1 for load cell

## PROOF LOAD:

Each system tested to 200% (certified)

## ACCURACY:

± 0.1% of full range

## DISPLAY:

4 digit Liquid Crystal Display (LCD) and annunciators: units, setpoint state, measuring rate, time and date, max, total, low battery, operating instructions, and messages

## UNITS:

Selectable by user (metric tons, lb, short tons, British tons and kilo-newtons)

## LOAD CELL:

High strength, aerospace quality, alloy steel, polyurethane coated

Hook and lifting eye are Crosby-Laughlin or equivalent

## POWER:

Rechargeable batteries provide power for up to 25 hours continuous use. All data settings are retained at power off

## FUNCTION KEYS:

SP1: Each setpoint has one point to turn on and one to turn off  
SP2: Each setpoint has one point to turn on and one to turn off  
CAL: User calibration  
SAMPLE: Selects measuring rate and display update: 0.2, 0.5 and 1 second. Idle for restless and dynamic loads

## FUNCTION KEYS (CONT.):

PRINT: Prints any available data (current measured value, peak hold, total Data Logger content) selected by the user  
CLOCK: Displays time and date by user request  
MAX: displays the maximum measured value (peak hold)  
TOTAL: Displays accumulated value (6 digits)  
ZERO: Zeroing of display

## CALIBRATION:

Factory calibrated, fully traceable (certificated)

## TEMPERATURE RANGE:

14°F to 140°F (-10°C to 60°C)

## ENVIRONMENTAL:

Weatherproof, NEMA 4, IP65

## INPUTS/OUTPUTS:

9-pin D-type female connector

Analog output: 0-2V

Serial output: RS-232 communication at 9600 baud rate

Modulated output: Frequency modulated line for remote use

Setpoint: Control output with adjustable hysteresis

Charge: charging input including charge control light

## APPROVALS:

CE marked

## WARRANTY:

One year limited warranty

## RON 2300 HOOK TYPE

PART #	CAPACITY	A	B	C	D Ø	E	H
69654.....	2000 lb x 1.0 lb.....	2.0"	1.5"	0.875"	0.5"	1.0"	10.0"
69655.....	6000 lb x 1.0 lb.....	2.625"	2.0"	1.125"	0.75"	1.125"	11.5"
69656.....	10,000 lb x 10.0 lb.....	3.5"	2.5"	1.5"	1.0"	1.4375"	13.0"
69657.....	20,000 lb x 10.0 lb.....	4.0"	3.125"	2.25"	1.25"	2.25"	19.0"

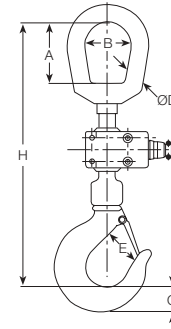

## RON 2300 SHACKLE TYPE (SHACKLES NOT INCLUDED - refer to catalog page CS-9)

PART #	CAPACITY	LOAD CELL WEIGHT	ELEC. LEAD LENGTH	H1 MAX.	H2 MAX.	B MAX.	D1 MAX.	D2 MIN.	ANCHOR/SHACKLE
69697....	2000 lb x 1.0 lb .....	0.7 lb (0.3 kg).....	16'	4.8"	3.7"	0.7"	1.2"	0.66"	1/2", 7/16", 3/8"
69698....	6000 lb x 1.0 lb .....	0.7 lb (0.3 kg).....	16'	5.4"	4.0"	0.75"	1.5"	0.82"	5/8", 1/2"
69699....	10,000 lb x 10.0 lb .....	1 lb (0.4 kg).....	16'	5.7"	4.2"	1.0"	1.75"	0.9"	3/4", 5/8"
69700....	20,000 lb x 10.0 lb .....	2.7 lb (1.2 kg).....	16'	7.7"	5.3"	1.6"	2.4"	1.4"	1 1/4", 1 1/8", 1"
69701....	25,000 lb x 20.0 lb .....	2.7 lb (1.2 kg).....	16'	7.7"	5.3"	1.6"	2.4"	1.4"	1 1/4", 1 1/8", 1"
69702....	30,000 lb x 20.0 lb .....	5 lb (2.3 kg).....	32'	8.1"	5.3"	1.8"	2.8"	1.4"	1 1/4", 1 1/8"
69703....	40,000 lb x 20.0 lb .....	5.5 lb (2.5 kg).....	32'	8.7"	5.6"	2.1"	3.2"	1.55"	1 3/8"
69704....	50,000 lb x 20.0 lb .....	7.3 lb (3.3 kg).....	32'	9.2"	5.9"	2.3"	3.4"	1.7"	1 1/2"
69705....	60,000 lb x 20.0 lb .....	7.3 lb (3.3 kg).....	32'	9.2"	5.9"	2.3"	3.4"	1.7"	1 1/2"
69706....	80,000 lb x 20.0 lb .....	16 lb (7.3 kg).....	49'	11.8"	7.6"	2.8"	4.5"	2.3"	2", 1 3/4"
69707....	100,000 lb x 200.0 lb ..	16 lb (7.3 kg).....	49'	11.8"	7.6"	2.8"	4.5"	2.3"	2", 1 3/4"
69708....	160,000 lb x 200.0 lb ..	36 lb (16 kg).....	65'	15.8"	10.4"	3.8"	5.7"	3.0"	2 1/2"
69709....	250,000 lb x 200.0 lb ..	66 lb (30 kg).....	81'	18.0"	11.8"	4.8"	6.5"	3.18"	Crosby #2160, 125t
69710....	400,000 lb x 200.0 lb ..	121 lb (55 kg).....	98'	22.8"	15.0"	5.7"	8.3"	4.2"	Crosby #2160, 200t

